

MGS Nemo RH

Single lever mixer

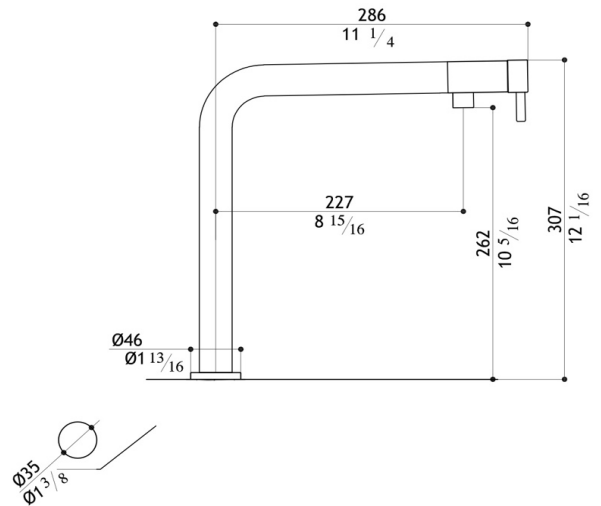

Specifications:

- **Marine Grade Stainless steel AISI316L**
- 100% lead free – fully recyclable
- The spout rotates 270°
- Positioning of the mixer on the head of the faucet
- Easy removal from the base for behind sink access
- Areas of application: Indoor & outdoor
- Flow rate: 1.75 GPM at 45 PSI in conformity with CalGreen and WaterSense requirements
- Flow rate EU: 8.5 L/Min at 3 Bar

Available Finishes:



Stainless Steel



Black Steel



Titanium



Rose Gold



Gold

Engineered in Switzerland



Made in Italy